

IMPORTANT! Keep these user instruction for reference.

Before using the SPARTUS® full face mask 90 and the related filters, must carefully read and understand the instruction, and strictly abide by the relevant content and retention of instruction in use process, please reference. The mask meet the requirement of Regulation (EU) 2016/425 and CE marked accordingly, and have been tested according to EN 136:1998.

Assembly instructions

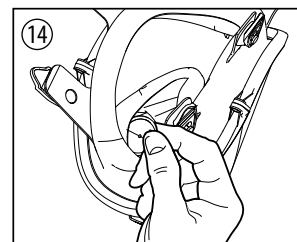
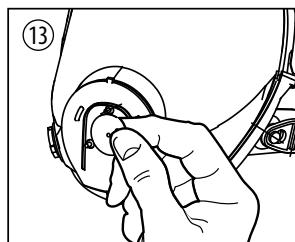
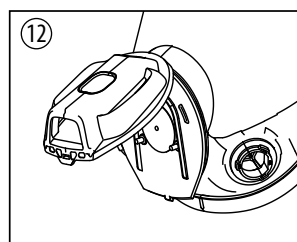
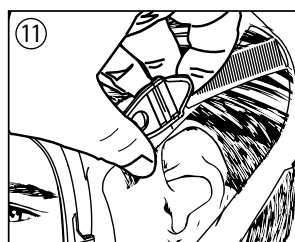
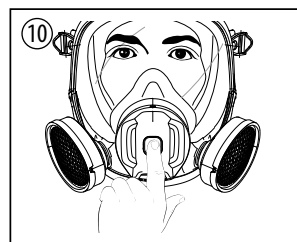
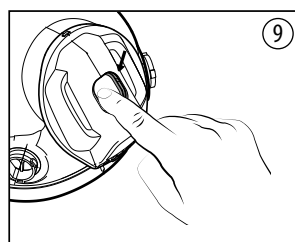
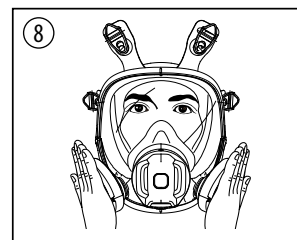
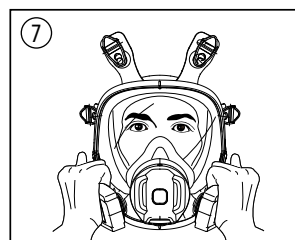
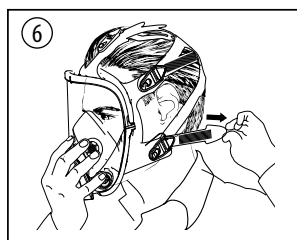
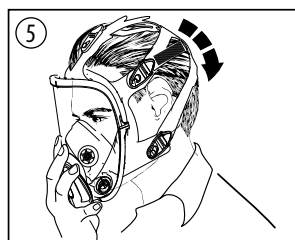
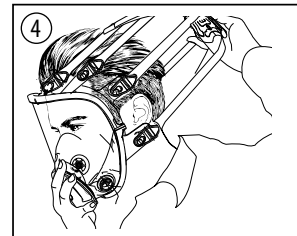
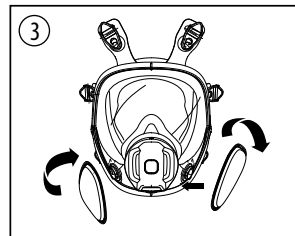
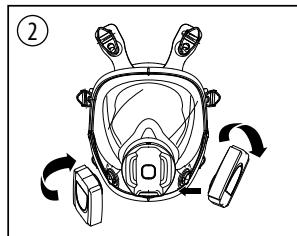
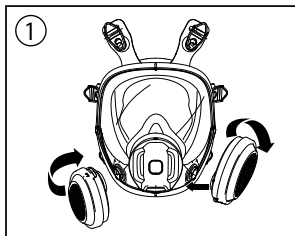

① / ② / ③ **Assemble or replace gas / particle filter:** Align gas/particle filter notch with the bump on facepiece, and push together. Turn gas/particle filter clockwise to stop. When replacing the gas/particle filter, remove the gas/particle filter by turning it counterclockwise. ④ **Mask fitting:** Hold the head harness and cardle away from your face, place your chin where the facepiece fits against the chin, and press the respirator against your face so that it fits your face. ⑤ Pull the head harness assembly behind the head. ⑥ Tighten the lower straps one by one, paying attention to the same tightness on both sides. ⑦ **Checking the tightness of the particule filter:** Using hands press or squeeze filter covers toward facepiece and inhale gently. If you feel facepiece collapse slightly and pull closer to your face with no leaks between the face and facepiece, a proper seal has been obtained. ⑧ **Checking the tightness of the gas filter:** Place the palm of hands to cover face of gas filter and inhale gently. If you feel facepiece collapse slightly and pull closer to your face with no leaks between the face and facepiece, a proper seal has been obtained. ⑨ After wearing this respirator, press the „Positive Fit Check Button” with your finger to the bottom. ⑩ Exhale slowly, the facepiece will bulge slightly. If the respirator can maintain a little positive pressure and there is no obvious leakage between the face and the facepiece, it means that the seal is good. ⑪ **Respirator removal:** Pull the buckle of head harness to fully loosen the 6 head harness straps. ⑫ **Replace the exhalation valve:** Open the bottom buckle of exhalation valve cover with your finger and remove it. ⑬ Remove the exhalation valve from the valve seat by pulling valve stem from valve seat. Replace exhalation valve by inserting stem into hole and manipulating stem tip until valve seat completely. The valve is flat and free to move. ⑭ **Replace the inhalation valve:** Remove the inhalation valve from the valve seat by pulling valve stem from seat. Replace inhalation valve by inserting stem into hole and manipulating stem tip until valve seat completely. The valve is flat and free to move.

Use instructions

SPARTUS® full face mask is used two filters to protect people from harmful working environment. And the protection performance is depend on the filters.

SPARTUS® full face respirator is compatible with the following combined filters:

Filter model	Protection against
SPARTUS®50	For use against organic gases and vapors with boiling point > 65°C
SPARTUS®100 / SPARTUS®200	For use against certain organic gases and vapors, certain inorganic gases and vapors, sulfur dioxide and other acidic gases and vapors, ammonia and organic ammonia derivatives
SPARTUS®10 / SPARTUS®60	For use against protect against solid or liquid substance in the nely divided state

(for use with twin filtering device)

Warning

Leave the contaminated area immediately and replace respirator if:

- the full mask becomes damaged;
- you taste or smell contaminants or an irritation occurs;
- breathing becomes difficult;
- dizziness or other distress occurs.

1. The full face mask does not supply oxygen. Please do not use in atmosphere containing less than 19.5% oxygen.
2. Do not use this mask in oxygen enriched air and explosive atmosphere.
3. It is unlikely that the requirements for leakage will be achieved if facial hair passes under the face seal.
4. Check prior to use, ensure fit of face piece.
5. The mask must be used with two filters.
6. Stay away from the contaminated areas when replacing the filters.
7. If you cannot achieve a proper fit, do not enter the contaminated area.

Inspection procedure

SPARTUS® full face mask must be inspected before use to ensure that it is in good operating condition. The mask should be replaced upon observation of damaged or defective parts. The following inspection procedure is suggested:

1. Check the mask for any cracks, tears and/or dirt.
2. Check the inhalation valve, exhalation valve, valve seat for deformation, dirt, impurities, cracks or signs of rupture.
3. Make sure that the head straps are intact and have a good elasticity.
4. Examine all plastic and rubber parts for signs of cracking or fatiguing.
5. Check to ensure breathing is smooth and there is no leaking.
6. Examine to ensure that filters are compliant with the working environment.
5. Check the lenses for any damage that may affect the performance or visual eld of the respirator. Make sure the protective film has been removed.

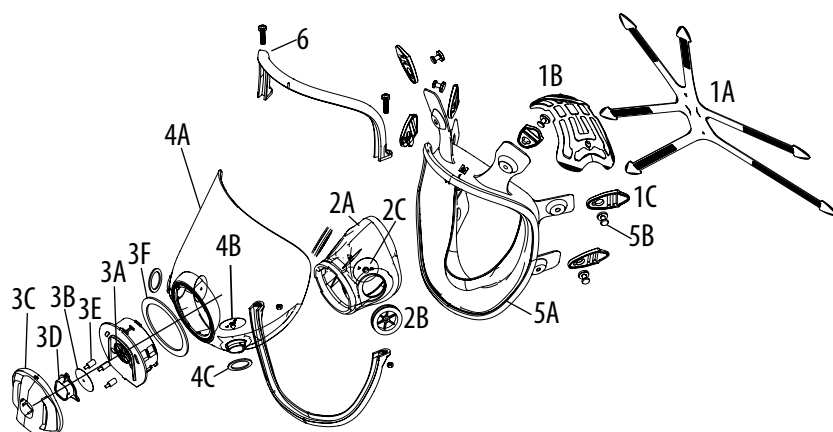

- 1A Head Harness
- 1B Head Harness Cradle
- 1C Head Harness Buckle
- 2A Nose Cup
- 2B Inhalation Valve Seat
- 2C Inhalation Valve
- 3A Exhalation Valve Seat
- 3B Exhalation Valve
- 3C Exhalation Valve Cover
- 3D Positive Fit Check Button
- 3E Spring Column
- 3F Center Adapter Gasket
- 4A Lens
- 4B Inhalation Valve
- 4C Inhalation Gasket
- 5A Facepiece
- 5B Head Harness Button
- 6 Frame Assembly w/ Screws

Cleaning and storage instructions

Cleaning is recommended after use:

- remove the filters before cleaning,
- immerse the respirator and its components (excluding filters) in clean warm water at a temperature not exceeding 49°C. Gently brush with a soft bristle brush. If necessary, add neutral detergent, without lanolin or other oils,
- use broad-spectrum disinfectants for disinfection to prevent the spread of bacteria. Special attention should be paid to the instructions of the disinfectant manufacturer, such as dilution ratio, temperature and disinfection time,
- to maintain and extend the product in good condition, the cleaned respirator should be stored away in its original packaging or in a container box from contaminated areas when not in use. Always remember to store away from direct daylight or any source of heat.
- storage life: 5 years from date of manufacture.

Maintenance

The replacement parts and components must be from the original manufacturer. Otherwise, the protective effect of the respirator may be affected, and even cause illness or death.

The exhalation valve

1. Open the bottom buckle of exhalation valve cover with your finger and remove it.
2. Remove the exhalation valve from the valve seat by pulling valve stem from valve seat.
3. Check the exhalation valve seat to ensure that it is clean and in good condition.
4. Replace exhalation valve by inserting stem into hole and manipulating stem tip until valve seat completely.

The valve is at and free to move.

5. Replace the exhalation valve cover.

NOTE: Conduct a negative pressure seal check to ensure that the exhalation valve is functioning properly.

The inhalation valve

1. Remove the inhalation valve from the valve seat by pulling valve stem from seat.
2. Check the inhalation valve seat to ensure that it is clean and in good condition.
3. Replace inhalation valve by inserting stem into hole and manipulating stem tip until valve seat completely.

The valve is at and free to move.

NOTE: Conduct a positive pressure seal check to ensure that the inhalation valve is functioning properly.

Product manufacturing date

The parts of the product show markings that bring information of manufacturing date, and its reading is described as in the example below:



Date code = 07th month , 2022 year (07.2022)

Maintenance

Use only original spare parts. After use the SPARTUS® full face mask 90 must be checked and cleaned. Replace damaged parts.

Pictogram legend



See manufacturer's instruction manual



Maximum humidity during storage



End of storage time



Reusable particulate filter



Storage temperature range

SPARTUS® FILTERS

Before using the SPARTUS® filters, please carefully read and understand the instructions, and strictly follow it. Improper use may cause serious injury, harm to your health or death.

Use instructions

1. Check the filter and package prior to use. Ensure the filter is good condition. Do not use if there are hole, deformation, crack on the filter.
2. Filter can only be used according to its type and class. See marking on the filter before use. Choose appropriate to use.
3. In case, if you experience increased breathing resistance, you smell contaminants or feel dizziness, headache, irritation or any other discomfort, you should leave the dangerous area immediately and replace filter.

Warning

1. The filter don't produce oxygen, use in normal breathing air quality, do not use in hazards of oxygen, deficiency of oxygen or oxygen enriched air.
2. The use of gas or combined respiratory protective devices, specially those which are not directly connected to the face piece during work with open flames or liquid metal droplets may cause serious risk due to the ignition of the charcoal containing filters which may generate acute levels of toxic substances.
3. Don't use in explosive atmosphere.
4. Storage under conditions other than those specified by the manufacturer may affect the shelf life.
5. Follow guidance as to use of filters.
6. Don't modify and abuse of the product.

Use limitations

SPARTUS® filters never be used under following conditions:

- oxygen concentration is lower than 19,5%,
- in an oxygen-enriched environment where oxygen concentration 23,5% and increase.
- the type of poison is unknown (the filter is only used according to its type and classification on the marking),
- the concentration of harmful gases not exceeds 0,1%,
- for specific applications, contact the distributor or manufacturer.

Maintenance

Gas filter is not re-usable – do not need cleaning or maintenance. Particle filter is re-usable – take off the particle filter after using and store it in its original packaging.

Storage conditions

Storage under conditions specified by the manufacturer, otherwise it may affect its classification and shelf life. Particle filter shall be stored in the dry, clean, low humidity and non-pollution environment. Do not use out of shelf life.

SPARTUS® gas filters

The service life of gas filter is affected by the type, volatility and concentration of air pollutants and environmental conditions, such as temperature, atmospheric pressure and humidity. SPARTUS® gas filters meet the requirement of Regulation (EU) 2016/425 and CE marked accordingly, and have been tested according to EN 140:1998.

Specification

Marking: ①Type / ②Protection against gases and vapours / ③Filter colour: A-Brown, B-Grey, E-Yellow, K-Green / ④A – for use against organic gases and vapors with boiling point > 65°C / ⑤B – for use against certain inorganic gases and vapours / ⑥E – for use against sulphur dioxide and other acidic gases and vapours / ⑦K – for use against ammonia and organic ammonia derivatives

①Type	②Protection against gases and vapours	③Colour
A1	④A	Brown
B1	⑤B	Grey
E1	⑥E	Yellow
K1	⑦K	Green
A1 E1	④A ⑥E	Brown, Green
A1 B1	④A ⑤B	Brown, Grey
A1 B1 E1	④A ⑤B ⑥E	Brown, Grey, Green
B1 E1 K1	⑤B ⑥E ⑦K	Grey, Yellow, Green
A1 B1 E1 K1	④A ⑤B ⑥E ⑦K	Brown, Grey, Yellow, Green

(listed above features for use with twin filtering device)

Marking meaning

Marking	Filter class	Protection against	Colour
A1	1	For use against organic gases and vapors with boiling point > 65°C	Brown
B1	1	For use against certain inorganic gases and vapours	Grey
E1	1	For use against sulphur dioxide and other acidic gases and vapours	Yellow
K1	1	For use against ammonia and organic ammonia derivatives	Green

(class 1 is low capacity filters)

SPARTUS® particle filter

The service life of the particle filter is affected by such factors as the concentration of particulate matter in the air, the user's respiratory rate, ambient temperature and humidity conditions. If the particulate filter is dirty, damaged or the inhalation resistance increases significantly, it must be replaced immediately. SPARTUS® particle filter meet the requirement of Regulation (EU) 2016/425 and CE marked accordingly, and have been tested according to EN 14387:2004+A1:2008.

Specification

Model	Type	Protection against
SPARTUS®10 / SPARTUS®60	P3 R	For use against protect against solid or liquid substance in the finely divided state

(particle filter is intended to be used for more than a single shift – mark „R“)